

## ULTIMAXX 900 with roller brush

### Preparation



1 Unplug machine when batteries are fully charged



2 Open lid of machine

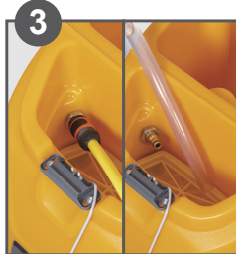

3 Fill tank with water



4 Dose chemicals manually



5 Or with using IntelliDose +



6 Place the brushes



7 Connect the hose to the squeegee



8 Lower brush units by using the manual lever (by foot)



9 And lower the squeegee



10 Adjust handle for perfect working position



11 Start machine by pushing the key



12 Start water, vacuum motor and choose water level

### Operation



13 Pull levers to start cleaning



14 Lift brush unit



15 Lift squeegee



16 Empty the tank



17 Remove squeegee and rinse with water



18 Check filter and rinse with water



19 Remove brushes

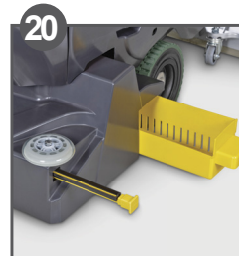

20 Empty and clean hopper and the spray unit



21 Remove filter



22 Empty filter and rinse with water



23 Check filter and rinse with water



24 Store machine with open lid



25 Plug machine in if needed

## ATTENTION!

Do not use the machine before you have read and understood the operating instructions!

Questions: 1-800-558-2332